

# CAR - Metal Backdraft Damper

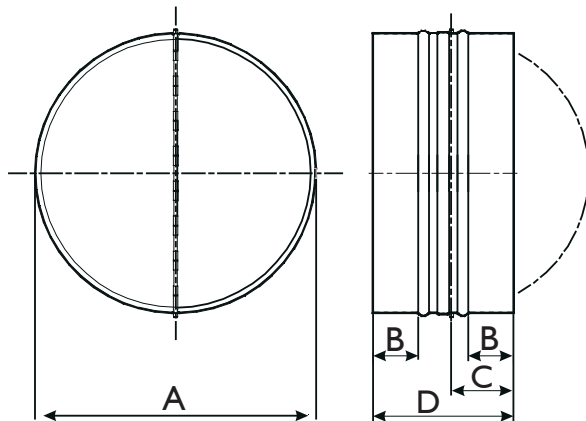

The World's Leading Producer of  
**Air Movement Products**  
 6393 Powers Avenue  
 Jacksonville, Florida 32217-2298  
 P: 800.961.7370 F: 800.961.7379  
 www.solerpalau-usa.com



## Dimensions inches/mm

Model	A	B	C	D	Weight (lbs)
CAR-100	100 3 15/16		32 1 4/16	80 3 2/16	1
CAR-125	125 4 15/16		42 1 10/16	100 3 15/16	1
CAR-150	150 5 15/16		52 2 1/16	120 4 12/16	1
CAR-200	200 9 15/16		52 2 1/16	120 4 12/16	1
CAR-250	250 11 15/16		62 2 7/16	140 5 8/16	1
CAR-315	315 12 2/5		62 2 7/16	140 5 8/16	2

ACCESSORY MODEL	1	2	3	4	5	REMARKS

PROJECT: \_\_\_\_\_ CONTRACTOR: \_\_\_\_\_  
 LOCATION: \_\_\_\_\_ REVISION DATE: \_\_\_\_\_  
 FORM NO.: \_\_\_\_\_ SUBMITTED BY: \_\_\_\_\_ DATE: \_\_\_\_\_  
 ENGINEER: \_\_\_\_\_ APPROVED BY: \_\_\_\_\_ DATE: \_\_\_\_\_

For more information contact us at [www.solerpalau-usa.com](http://www.solerpalau-usa.com) or 1.800.961.7370 for additional submittal drawings.

Soler & Palau will not be responsible for fabrication changes or errors resulting from customer use of a non-current submittal drawing.

