



DBM - 100xp

for Clothes Dryer Boosting



The World's Leading Producer of Air Movement Products

Clothes Dryer Boosting with a . . . Duct Mounted Pressure Sensor

The DBM-100xp is the latest addition to S&P's line of dryer kits. The kit includes the durable PV-100X, and a pressure switch that is pre-wired and affixed to an 8" length of 4" rigid duct. (Now with a pre-mounted and wired pressure switch you have even more flexibility and an easier installation!)

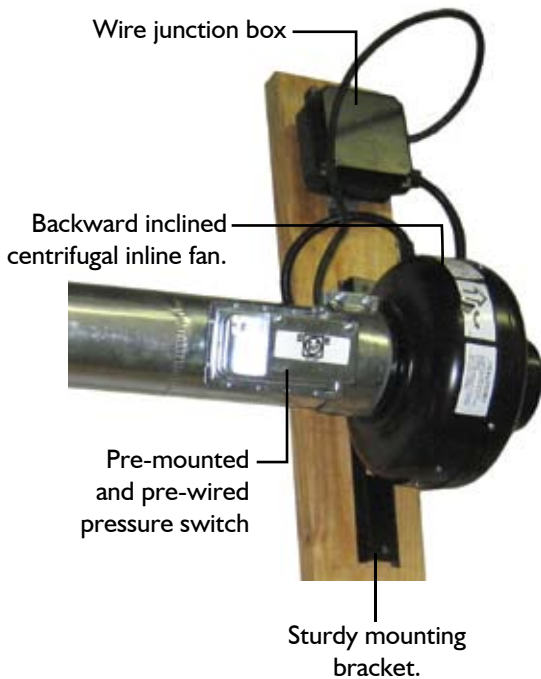

- Easy installation!
- Pre-mounted and wired
- Can mount on intake or exhaust side of fan
- Class F motor insulation
- Metal housing with baked powder coating for increased durability
- ETL listed

Pressure switches are a viable method of fan activation and a good solution for many installations. The pressure switch senses the pressure differential in the duct created by the dryer operation, thus activating the fan. Conversely, when the dryer is deactivated, the pressure switch senses this differential and the fan is deactivated. S&P does not mount the pressure switch to the fan so that

the most advantageous location for the pressure switch can be determined by the installer for ease of maintenance and accessibility. The pressure switch should not be installed too far from the dryer's exhaust outlet (no more than 15 feet optimally), this decreases the risk of not having sufficient detectable pressure.

Also available:

DBF-100xc



Fan with Current Sensor

DBF-100xp



Fan with Unattached Pressure Switch

PV-100x Technical Data

Dimensions (in/mm)

Model	A	B	C	D	E	F	G	H	I	Weight lbs(kgs)
PV-100x	7 5/8 194	1 25	9 1/2 241	3 7/8 98	6 11/16 170	8 7/8 225	6 1/16 154	10 13/16 275	3 1/4 83	7 3.0

Air Performance

Model	Nom. RPM	Volts	Max. Watts	CFM v Static Pressure (SP) Ins. WG									Max. SP	Duct Dia. Ins.
				0"	0.125"	0.25"	0.375"	0.5"	0.75"	1.0"	1.25"	1.5"		
PV-100x	2880	115	84	153	142	130	120	111	96	80	63	34	1.85	4"



Soler & Palau USA certifies that the PV range shown herein is licensed to bear the AMCA Seal. The ratings shown are based on tests and procedures performed in accordance with AMCA Publication 211 and comply with the requirements of the AMCA Certified Ratings Program.



Sound

Fan sound levels are measured in sones. At this time there are no sone level test standards available through HVI due to the fact that remote mounted fan noise levels are in proportion to the following: type of duct, length of duct, fan distance from the intake source and other miscellaneous factors. However it is generally accepted that remote mounted venting is usually quieter than standard (in room) venting.

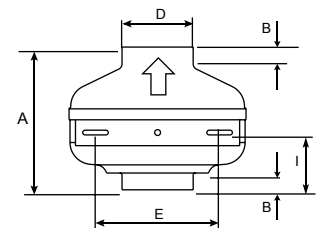
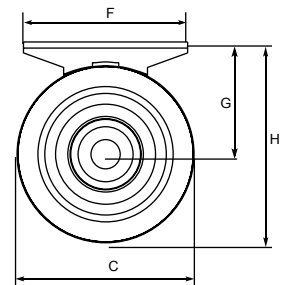

Distributed By:

Soler & Palau USA
6393 Powers Avenue
Jacksonville, FL 32217
800.961.7370
800.961.7379
www.solerpalau-usa.com

Soler & Palau Canada
61 A Baywood Road
Toronto, ON M9V 3Y8
866.733.0233
866.358.5346
www.solerpalaucanada.com