



MODEL TXD-UL762 (UL762 for sizes 10-15 only)

UPBLAST DIRECT DRIVE CENTRIFUGAL ROOF/SIDEWALL EXHAUSTER FOR RESTAURANT AND GENERAL APPLICATIONS



CENTRIFUGAL ROOF & WALL EXHAUSTERS

APPLICATION

Isolation of the motor from the air stream and the high velocity vertical (roof) or horizontal (wall) air discharge make the Model TXD ideally suited for the removal of dirty, contaminated and/or high temperature air from processes and buildings. Typical applications include restaurant hoods and similar kitchen exhaust ventilation, fume and smoke removal, laboratory fume hood exhaust and chemical process exhaust.

The nonoverloading wheel with its higher static pressure capability makes this unit suitable for either ducted or nonducted applications. Its roof or wall mounting permits location near the area to be ventilated, allowing short duct runs and more efficient operation. Direct drive units use smaller diameter wheels, resulting in low sound levels and quiet operation. They have no belts or fan bearings to maintain or adjust and consequently require very little maintenance.

CONSTRUCTION

Housing

- Heavy-gauge aluminum housing and curb cap for strength and rigidity.
- Stainless steel exterior fasteners.
- Enclosed, ventilated motor compartment isolates motor from exhaust air.
- Neoprene isolators for reduction of vibration and sound.
- The motor compartment housing easily removes for complete maintenance access.
- Water-tight conduit tube for easy electrical connection without having to wire through the breather tube.
- Mounted disconnect is included on standard models.

Centrifugal Wheel

- Nonoverloading backward inclined for safe operation in ducted systems.
- Wheels constructed of noncorrosive aluminum.
- Statically and dynamically balanced for smooth operation.

DIMENSIONAL DATA

MODEL TXD	A	B	C	D	ROOF OPENING	Average Ship Wt. Lbs.
6	24	22	16 1/2	2	12	70
8	24	22	16 1/2	2	12	70
10	27 1/4	22	16 1/2	2	12	73
12	31 1/2	23	24	2	19 1/4	115
14	31 1/2	23	24	2	19 1/4	120
15	31 1/2	23	24	2	19 1/4	120

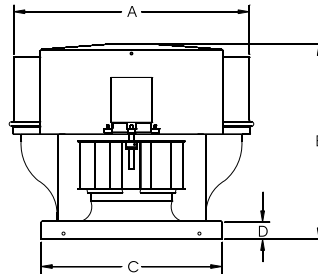

Ship Schedules:
● Next Day Shipment From Stock
▲ 3 Day Shipment From Stock
◆ 10 Day Shipment

ACCESSORIES

MODEL TXD	RECOMMENDED 12" HIGH MOUNTING CURB		RECOMMENDED GRAVITY DAMPER		DAMPER MOTOR (LOOSE)	115 VOLT SPEED CONTROL	230 VOLT SPEED CONTROL	WALL MOUNT KIT	WALL MOUNT ADAPTER
	OD	STOCK NO.	OD	STOCK NO.	STOCK NO.	STOCK NO.	STOCK NO.	STOCK NO.	STOCK NO.
6	15	611214 ●	11	411011 ●	411611 ●	2727.1 ●	3232.1	100409 ●	700708-2 ●
8	15	611214 ●	11	411011 ●	411611 ●	2727.1 ●	3232.1	100408 ●	700708-2 ●

Sizes 6-8 are not suitable for Restaurant applications

MODEL TXD	RECOMMENDED 12" HIGH MOUNTING CURB		18" HIGH MOUNTING CURB		RECOMMENDED GRAVITY DAMPER		DAMPER MOTOR (LOOSE)	115 VOLT SPEED CONTROL		230 VOLT SPEED CONTROL
	OD	STOCK NO.	OD	STOCK NO.	OD	STOCK NO.	STOCK NO.	STOCK NO.	STOCK NO.	STOCK NO.
10	15	611214 ●	22	621815V ●	11	411011 ●	411611 ●	2727.1 ●	N/A	3232.1 ◆
12	22 1/4	611222 ●	22	621823V ●	18	411018 ●	411611 ●	2727.1 ●	2828.1 ●	3232.1 ◆
14	22 1/4	611222 ●	22	621823V ●	18	411018 ●	411611 ●	2727.1 ●	N/A	3232.1 ◆
15	22 1/4	611222 ●	22	621823V ●	18	411018 ●	411611 ●	N/A	2828.1 ●	3232.1 ◆

*You can not use a damper in a grease application

MODEL TXD	WALL MOUNT KIT	WALL MOUNT ADAPTER	HINGED BASE KIT	METAL GREASE BOX	GREASE GRABBER
	STOCK NO.	STOCK NO.	STOCK NO.	STOCK NO.	STOCK NO.
10	100406 ●	700708-2 ●	98028001HD ●	90005891-A ●	708971 ●
12	100407 ●	700709-2 ●			
14	100407 ●	700709-2 ●			
15	100407 ●	700709-2 ●			

SPEED CONTROL

2727.1 MAX 1/3 HP-5 AMP 120V
2828.1 MAX 1/2 HP-10 AMP 120V

Speed Controllable Motors

- Standard motors are single speed, speed controllable and drip-proof.
- All motors are rated for continuous duty.
- Disconnect is standard with single speed drip-proof motors.
- Motors ship mounted as standard.

ACCESSORIES

Solid State Speed Control:

Control is matched to the motor and blower wheel to allow continuous reduction in performance allowing adjustments of airflow for system balancing. CFM is reduced in direct proportion to motor speed reduction. Speed control is only available for single phase. Exhauster performance can be controlled from the ventilated area.

AMCA SEAL



Soler & Palau USA, certifies that the Models TXD shown herein are licensed to bear the AMCA Seal. The ratings shown are based on test and procedures performed in accordance with AMCA Publication 211 and AMCA Publication 311 and comply with the requirement of the AMCA Certified Ratings Program.



LISTED POWER ROOF VENTILATOR
UL STANDARD 705 sizes 6-8
UL STANDARD 762 sizes 10-15 **ONLY**

ALL DIMENSIONS IN INCHES, WEIGHTS IN POUNDS. OD IS OUTSIDE DIMENSION OF SQUARE CURB AND DAMPER. DUE TO CONTINUING RESEARCH, SOLER & PALAU RESERVES THE RIGHT TO CHANGE SPECIFICATIONS WITHOUT NOTICE.

Please refer to the General Catalog or contact the Factory for our Full Line of products available on standard shipping schedules.

MODEL TXD					Upblast Direct Drive Centrifugal Roof/Sidewall Exhauster									Ventilator with Open Drip-proof Motor	
Model TXD	Motor Hp	Max. BHp	RPM	Sones @ 1/8 SP	CFM at Static Pressure									115/1/60	208-230/1/60
					0	1/8	1/4	3/8	1/2	5/8	3/4	7/8	1	Stock No.	Stock No.
6	1/10	0.09	1795	7.7	410	370	328	276	203	-	-	-	-	TXD06JH1AS ●	TXD06JH1CS ◆
8	1/4	0.07	1130	6.2	886	783	644	441	-	-	-	-	-	TXD08MM1AS ●	TXD08MM1CS ◆
	1/4	0.24	1740	13.8	1364	1300	1232	1158	1072	960	851	698	510	TXD08MH1AS ●	TXD08MH1CS ◆
10	1/4	0.27	1650	14.7	1527	1460	1398	1325	1236	1129	1011	883	747	TXD10RHULMH1AS ●	TXD10RHULMH1CS ◆
12	1/4	0.16	1140	9.6	1616	1487	1338	1161	983	760	462	-	-	TXD12RHULMM1AS ●	TXD12RHULMM1CS ◆
	1/2	0.55	1730	21.0	2453	2364	2281	2196	2097	1985	1867	1751	1638	TXD12RHULQH1AS ●	TXD12RHULQH1CS ◆
14	1/4	0.25	1130	10.4	2060	1939	1798	1638	1439	1177	856	-	-	TXD14RHULMM1AS ◆	TXD14RHULMM1CS ◆
15	1/2	0.41	1155	13.2	2786	2653	2491	2313	2104	1863	1623	1362	969	TXD15RHULQM1AS ◆	TXD15RHULQM1CS ◆
	3/4	0.70	1650	22	3044	2964	2887	2811	2736	2659	2582	2502	2420	TXD15RHULRH1AS ◆	-

Speed (RPM) shown is nominal. Performance is based on actual speed of test.
 Performance certified is for installation type A-free inlet, free outlet.
 Performance ratings include the effects of birdscreen in the airstream.

The sound ratings shown are the loudness values in the fan sones @ 5' (1.5m) in an hemispherical free field calculated per AMCA Standard 301.
 Installation Type A: free inlet hemispherical sone levels.

Performance Data at Reduced Speed														
Model TXD	Motor Hp	Max. BHp	RPM	Sones @ 1/8 SP	CFM at Static Pressure									
					0	1/8	1/4	3/8	1/2	5/8	3/4	7/8	1	
6-1550	1/10	0.02	1150	2.4	253	185	-	-	-	-	-	-	-	-
		0.05	1470	5.1	335	286	227	115	-	-	-	-	-	-
8-1075	1/4	0.01	680	1.2	533	302	-	-	-	-	-	-	-	-
		0.03	860	3.2	674	525	-	-	-	-	-	-	-	-
		0.05	1040	5.2	815	701	536	-	-	-	-	-	-	-
8-1625	1/4	0.10	1405	9.3	1101	1021	930	814	673	468	-	-	-	
10-1625	1/4	0.10	1185	7.8	1097	1007	896	742	561	318	-	-	-	
		0.20	1500	12.3	1388	1316	1245	1155	1043	914	771	615	407	
12-1075	1/4	0.03	680	3.3	964	712	352	-	-	-	-	-	-	
		0.08	905	6.5	1283	1116	897	649	-	-	-	-	-	
12-1625	1/2	0.17	1175	10.2	1666	1540	1399	1228	1060	855	599	-	-	
		0.32	1445	14.9	2049	1945	1844	1724	1586	1446	1310	1152	969	
14-1075	1/4	0.05	680	3.6	1240	1011	609	-	-	-	-	-	-	
		0.13	905	6.8	1650	1491	1294	1020	617	-	-	-	-	
15-1140	1/2	0.05	570	3.1	1375	1027	422	-	-	-	-	-	-	
		0.18	885	8.2	2135	1948	1710	1406	1087	-	-	-	-	

Model in reduced speed table indicates size and motor RPM of base unit.
 Performance is for that base unit operated at a reduced speed using the solid state speed control accessory.

AMCA Seal for sound rating does not apply to units with speed control.

Use 5 AMP Speed Control for motors 1/3 HP and smaller.
 Use 10 AMP Speed Control for motors 1/2.