

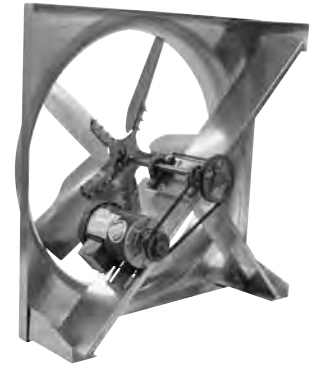

MODEL LCE/LCS

SIDEWALL BELT DRIVE PROPELLER FAN

LCE=Exhaust
LCS=Supply



APPLICATION

Model LCE (exhaust) and LCS (supply) are high capacity belt driven propeller fans. Their primary application is the exhaust or supply of large volumes of air at relatively low static pressures from commercial, light industrial and agricultural buildings such as manufacturing and assembly plants, warehouses, parking garages, gymnasiums, equipment rooms, distribution centers, poultry and greenhouses.

Belt driven fans provide large volumes of air at low fan speeds and low noise levels and afford quick, easy performance adjustments.

When suspended from the ceiling, thus keeping floor spaces open, model LC can be installed to direct large volumes of air downward toward work centers improving employee comfort and productivity.

CONSTRUCTION

Panel Assembly

- Heavy-gauge galvanized steel.
- All welded motor & drive support frame assembly.
- Prepunched mounting holes.

Propeller

- Die formed galvanized steel blades.
- Epoxy coated hub keyed to fan shaft.
- Statically and dynamically balanced.

Drives

- Sized for minimum 150% of drive horsepower.
- Single belt adjustable pitch sheaves through 3 HP.
- Nonstatic v-belts.

Bearings

- Designed for minimum 200,000 hour life.
- Bearings are sealed, prelubricated with relube fittings.

Motors

- Open drip-proof construction is standard.
- All motors mounted and factory run tested.



Soler & Palau USA, certifies that the Models LC shown herein are licensed to bear the AMCA Seal. The ratings shown are based on test and procedures performed in accordance with AMCA Publication 211 and AMCA Publication 311 and comply with the requirement of the AMCA Certified Ratings Program.



UL STANDARD 705

PROPELLER WALL/DUCT FANS

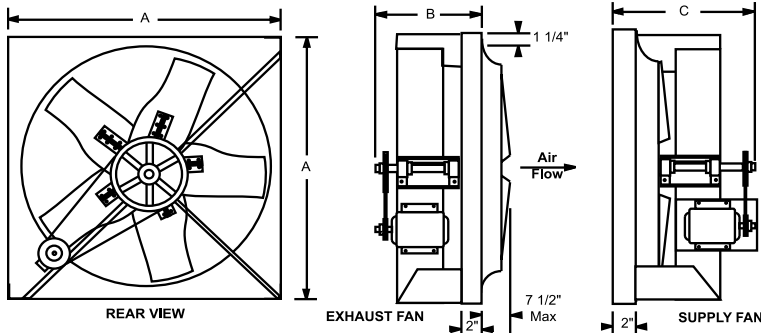

DIMENSIONAL DATA

| MODEL LC | A | B | C | Avg. Ship Wt. Lbs | FAN LESS MOTOR & DRIVES | |
|----------|----|----|----|-------------------|-------------------------|--------------|
| | | | | | STOCK NO. | MAX MOTOR Hp |
| 20 | 24 | 15 | 23 | 85 | LCE20LMDS ● | 3/4 |
| 24 | 30 | 15 | 23 | 90 | LCE24LMDS ● | 1 1/2 |
| 30 | 36 | 15 | 24 | 100 | LCE30LMDS ● | 1 1/2 |
| 36 | 42 | 15 | 24 | 105 | LCE36LMDS ● | 2 |
| 42 | 48 | 16 | 24 | 110 | LCE42LMDS ● | 2 |
| 48 | 54 | 16 | 24 | 125 | LCE48LMDS ● | 2 |
| 54 | 60 | 20 | 26 | 240 | LCE54LMDS ◆ | 3 |
| 60 | 66 | 20 | 26 | 285 | LCE60LMDS ◆ | 3 |

ACCESSORIES

| MODEL LC | RECOMMENDED DAMPER* (EXHAUST) | | DAMPER MOTOR (LOOSE) | WALL HOUSING PACK WITH GRAVITY DAMPER (EXHAUST)* | WALL HOUSING PACK WITH MOTORIZED DAMPER (EXHAUST)* | WALL HOUSING PACK WITH GRAVITY DAMPER (SUPPLY)* | RAINFOOD (EXHAUST)* | RAINFOOD (SUPPLY)* | RAINFOOD BIRDSCREEN (EXHAUST)* | RAINFOOD BIRDSCREEN (SUPPLY)* |
|----------|-------------------------------|-----------|----------------------|--|--|---|---------------------|--------------------|--------------------------------|-------------------------------|
| | OD | STOCK NO. | STOCK NO. | STOCK NO. | STOCK NO. | STOCK NO. | STOCK NO. | STOCK NO. | STOCK NO. | STOCK NO. |
| 20 | 22 1/2 | EAS20 ● | EAS1232MTR ● | WHPLCE20 ● | WHPLCE20M ▲ | WHPLCS20 ◆ | 5520.8.20KDS ● | 7520.8.20KDS ◆ | 5521.5.20RHS ● | 7521.5.20RHS ◆ |
| 24 | 28 1/2 | EAS26 ● | EAS1232MTR ● | WHPLCE24 ● | WHPLCE24M ▲ | WHPLCS24 ◆ | 5520.8.24KDS ● | 7520.8.24KDS ◆ | 5521.5.24RHS ● | 7521.5.24RHS ◆ |
| 30 | 34 1/2 | EAS32 ● | EAS1232MTR ● | WHPLCE30 ● | WHPLCE30M ▲ | WHPLCS30 ◆ | 5520.8.30KDS ● | 7520.8.30KDS ◆ | 5521.5.30RHS ● | 7521.5.30RHS ◆ |
| 36 | 40 1/2 | EAS38 ● | EAS3850MTR ● | WHPLCE36 ● | WHPLCE36M ▲ | WHPLCS36 ◆ | 5520.8.36KDS ● | 7520.8.36KDS ◆ | 5521.5.36RHS ● | 7521.5.36RHS ◆ |
| 42 | 46 1/2 | EAS44 ● | EAS3850MTR ● | WHPLCE42 ● | WHPLCE42M ▲ | WHPLCS42 ◆ | 5520.8.42KDS ● | 7520.8.42KDS ◆ | 5521.5.42RHS ● | 7521.5.42RHS ◆ |
| 48 | 52 1/2 | EAS50 ● | EAS3850MTR ● | WHPLCE48 ● | WHPLCE48M ▲ | WHPLCS48 ◆ | 5520.8.48KDS ● | 7520.8.48KDS ◆ | 5521.5.48RHS ● | 7521.5.48RHS ◆ |
| 54 | 58 1/2 | EAS56 ◆ | EAS5662MTR ◆ | WHPLCE54 ◆ | WHPLCE54M ◆ | WHPLCS54 ◆ | 5520.8.54KDS ◆ | 7520.8.54KDS ◆ | 5521.5.54RHS ◆ | 7521.5.54RHS ◆ |
| 60 | 64 1/2 | EAS62 ◆ | EAS5662MTR ◆ | WHPLCE60 ◆ | WHPLCE60M ◆ | WHPLCS60 ◆ | 5520.8.60KDS ◆ | 7520.8.60KDS ◆ | 5521.5.60RHS ◆ | 7521.5.60RHS ◆ |

* Refer to pages 65 & 66 for dimensions

ALL DIMENSIONS IN INCHES, WEIGHTS IN POUNDS. OD IS OUTSIDE DIMENSION OF SQUARE SHUTTER
DUE TO CONTINUING RESEARCH, SOLER & PALAU RESERVES THE RIGHT TO CHANGE SPECIFICATIONS WITHOUT NOTICE.
Please refer to the General Catalog or contact the Factory for our Full Line of products available on standard shipping schedules.

| MODEL LC | | | | | Sidewall Belt Drive Propeller Fan | | | | | | Ventilator with Open Drip-proof Motor and Drive Assembly | |
|-----------------|----------|---------|------|--------------|--|-------|-------|-------|-------|-------|---|--------------------------|
| Model LC | Motor Hp | Max BHP | RPM | SONES @ 0 SP | CFM at Static Pressure | | | | | | 115/1/60* | 208-230/460/3/60 |
| | | | | | 0 | 1/10 | 1/8 | 1/4 | 3/8 | 1/2 | STOCK NO. (LCE-Exhaust)* | STOCK NO. (LCE-Exhaust)* |
| 20 | 1/4 | 0.30 | 955 | 11.5 | 3983 | 3600 | 3491 | - | - | - | LCE20MH1S ● | LCE20MH3S ● |
| | 1/3 | 0.40 | 1050 | 13.5 | 4379 | 4038 | 3941 | 3312 | - | - | LCE20PH1S ● | LCE20PH3S ● |
| | 1/2 | 0.60 | 1180 | 16.4 | 4921 | 4625 | 4543 | 4081 | 3182 | - | LCE20QH1S ● | LCE20QH3S ● |
| | 3/4 | 0.90 | 1350 | 20.0 | 5630 | 5377 | 5308 | 4934 | 4462 | 3538 | LCE20RH1S ● | LCE20RH3S ● |
| 24 | 1/4 | 0.30 | 600 | 10.2 | 5331 | 4652 | 4431 | 2269 | - | - | LCE24MH1S ● | LCE24MH3S ● |
| | 1/3 | 0.41 | 660 | 12.1 | 5864 | 5268 | 5086 | 3702 | - | - | LCE24PH1S ● | LCE24PH3S ● |
| | 1/2 | 0.60 | 760 | 15.7 | 6753 | 6254 | 6112 | 5212 | - | - | LCE24QH1S ● | LCE24QH3S ● |
| | 3/4 | 0.90 | 875 | 19.8 | 7775 | 7352 | 7237 | 6562 | 5600 | - | LCE24RH1S ● | LCE24RH3S ● |
| | 1 | 1.20 | 950 | 22.0 | 8441 | 8057 | 7953 | 7369 | 6625 | 5559 | LCE24SH1S ● | LCE24SH3S ● |
| | 1 1/2 | 1.82 | 1100 | 28.0 | 9774 | 9447 | 9361 | 8894 | 8347 | 7688 | LCE24TH1S ● | LCE24TH3S ● |
| 30 | 1/4 | 0.30 | 450 | 9.0 | 7365 | 6062 | 5572 | - | - | - | LCE30MH1S ● | LCE30MH3S ● |
| | 1/3 | 0.40 | 495 | 10.5 | 8101 | 6954 | 6603 | - | - | - | LCE30PH1S ● | LCE30PH3S ● |
| | 1/2 | 0.59 | 565 | 13.3 | 9247 | 8271 | 7995 | 6052 | - | - | LCE30QH1S ● | LCE30QH3S ● |
| | 3/4 | 0.90 | 650 | 17.1 | 10638 | 9853 | 9594 | 8198 | - | - | LCE30RH1S ● | LCE30RH3S ● |
| | 1 | 1.20 | 715 | 20.0 | 11702 | 11021 | 10802 | 9659 | 8052 | - | LCE30SH1S ● | LCE30SH3S ● |
| | 1 1/2 | 1.78 | 815 | 24.0 | 13339 | 12773 | 12599 | 11609 | 10482 | 9013 | LCE30TH1S ● | LCE30TH3S ● |
| 36 | 1/3 | 0.41 | 390 | 9.7 | 10755 | 8745 | 7976 | - | - | - | LCE36PH1S ● | LCE36PH3S ● |
| | 1/2 | 0.59 | 440 | 11.9 | 12133 | 10449 | 9923 | - | - | - | LCE36QH1S ● | LCE36QH3S ● |
| | 3/4 | 0.90 | 505 | 15.3 | 13926 | 12485 | 12100 | 9348 | - | - | LCE36RH1S ● | LCE36RH3S ● |
| | 1 | 1.19 | 555 | 18.1 | 15305 | 14018 | 13663 | 11419 | - | - | LCE36SH1S ● | LCE36SH3S ● |
| | 1 1/2 | 1.79 | 635 | 22.0 | 17511 | 16413 | 16111 | 14497 | 12146 | - | LCE36TH1S ● | LCE36TH3S ● |
| | 2 | 2.37 | 695 | 25.0 | 19165 | 18176 | 17907 | 16499 | 14594 | 12363 | LCE36VH1S ● | LCE36VH3S ● |
| 42 | 1/3 | 0.41 | 305 | 8.4 | 13173 | 9658 | 8439 | - | - | - | LCE42PH1S ● | LCE42PH3S ● |
| | 1/2 | 0.60 | 345 | 9.8 | 14901 | 12109 | 11073 | - | - | - | LCE42QH1S ● | LCE42QH3S ● |
| | 3/4 | 0.90 | 395 | 12.6 | 17060 | 14724 | 14044 | 7292 | - | - | LCE42RH1S ● | LCE42RH3S ● |
| | 1 | 1.20 | 435 | 14.9 | 18788 | 16703 | 16128 | 12182 | - | - | LCE42SH1S ● | LCE42SH3S ● |
| | 1 1/2 | 1.81 | 500 | 18.8 | 21596 | 19833 | 19339 | 16470 | 11827 | - | LCE42TH1S ● | LCE42TH3S ● |
| | 2 | 2.40 | 550 | 22.0 | 23755 | 22182 | 21746 | 19393 | 16034 | - | LCE42VH1S ● | LCE42VH3S ● |
| 48 | 1/2 | 0.62 | 290 | 10.0 | 17979 | 13841 | 12199 | - | - | - | LCE48QH1S ● | LCE48QH3S ● |
| | 3/4 | 0.91 | 330 | 12.1 | 20459 | 16949 | 15969 | - | - | - | LCE48RH1S ● | LCE48RH3S ● |
| | 1 | 1.23 | 365 | 14.3 | 22629 | 19504 | 18659 | 10868 | - | - | LCE48SH1S ● | LCE48SH3S ● |
| | 1 1/2 | 1.82 | 415 | 17.8 | 25729 | 23054 | 22306 | 17746 | - | - | LCE48TH1S ● | LCE48TH3S ● |
| | 2 | 2.39 | 455 | 21.0 | 28209 | 25800 | 25148 | 21574 | 15382 | - | LCE48VH1S ● | LCE48VH3S ● |
| 54 | 3/4 | 0.92 | 270 | 11.0 | 23384 | - | 17932 | - | - | - | LCE54RH1S ♦ | LCE54RH3S ♦ |
| | 1 | 1.20 | 295 | 13.1 | 25550 | - | 20825 | - | - | - | LCE54SH1S ♦ | LCE54SH3S ♦ |
| | 1 1/2 | 1.84 | 340 | 16.8 | 29447 | - | 25449 | 19183 | - | - | LCE54TH1S ♦ | LCE54TH3S ♦ |
| | 2 | 2.38 | 370 | 19.4 | 32045 | - | 28375 | 23692 | - | - | LCE54VH1S ♦ | LCE54VH3S ♦ |
| | 3 | 3.60 | 425 | 24.0 | 36809 | - | 33585 | 30290 | 24785 | 15677 | N/A | LCE54WH3S ♦ |
| 60 | 1 | 1.21 | 265 | 11.5 | 28491 | - | 22275 | - | - | - | LCE60SH1S ♦ | LCE60SH3S ♦ |
| | 1 1/2 | 1.75 | 300 | 14.3 | 32254 | - | 27023 | - | - | - | LCE60TH1S ♦ | LCE60TH3S ♦ |
| | 2 | 2.44 | 335 | 17.1 | 36017 | - | 31464 | 25399 | - | - | LCE60VH1S ♦ | LCE60VH3S ♦ |
| | 3 | 3.56 | 380 | 21.0 | 40855 | - | 36826 | 32244 | 29351 | - | N/A | LCE60WH3S ♦ |

PROPELLER WALL/DUCT FANS

Performance ratings include the effects of appurtenances (accessories).
 Power ratings (BHP) do not include transmission losses.
 Performance certified is for installation type A-free inlet, free outlet.
 The sound ratings shown are loudness values in fan sones @ 5' (1.5m) in a hemispherical free field calculated per AMCA Standard 301.
 Installation Type A: free inlet hemispherical sone levels.
 *Tri-voltage (115-208-230) is standard on 3/4 through 1 1/2 Hp Single phase motors. Tri-voltage is available for the 1/2 Hp motors. Inquire for price and delivery.

NOTES:

*Stock Numbers shown are for LCE-Exhaust fans, for LCS-Supply fans replace the "E" with "S".

Example:

LCE-Exhaust = LCE20MH1S
 LCS-Supply = LCS20MH1S

| |
|--------------------------------|
| Ship Schedules: |
| ● Next Day Shipment From Stock |
| ▲ 3 Day Shipment From Stock |
| ♦ 10 Day Shipment |

LCS-Supply fans have a 10-day (♦) ship schedule

Please refer to the General Catalog or contact the Factory for our Full Line of products available on standard shipping schedules.